

Manual

Backpack gas sprayer

6.6 gal

FUG-254

Applies for:

Code	Model
101569	FUG-254

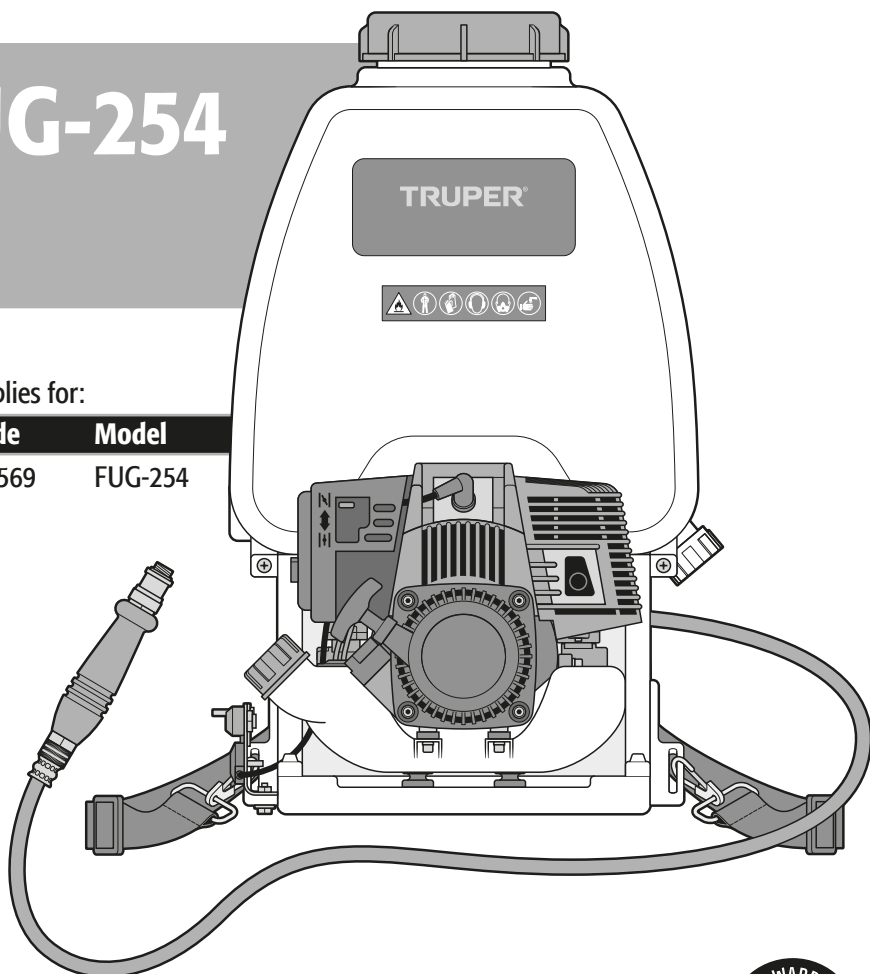

CAUTION



Read the user's manual thoroughly
before operating this tool.



Technical data	3
Fuel Specifications	3
 General motor tool safety warnings	4
 Safety Warnings for Using Sprayers	5
Parts	6
Assembly	7
Fuel Supply	8
Ignition	9
Tank filling	9
Operation	10
Maintenance	10
Accessories and spare parts	11
Troubleshooting	12
Authorized Service Centers	13
Warranty Policy	14

CAUTION

To gain the best performance of the tool, prolong the duty life, make the Warranty valid if necessary, and to avoid hazards of fatal injuries please read and understand this Manual before using the tool.

Keep this manual for future references.

The illustrations in this manual are for reference only. They might be different from the real tool.

Use and care recommendations



DO NOT start the machine **WITHOUT OIL** or the engine will suffer serious damage due to lack of lubrication.



For optimal **PERFORMANCE** and durability, use higher-octane gasoline. In Mexico, we recommend using **PREMIUM** gasoline.
AVOID USING contaminated gasoline or gasoline mixed with additives or oils.



Keep the engine's ventilation slots **CLEAR**.



Perform regular **MAINTENANCE** on your machine (Page 10).

FUG-254

Code •	101569
Description •	Backpack gas sprayer
Net Weight •	10 kg
Motor •	4 strokes 31 cc
Rated Motor Power •	1 Hp
Fuel Tank •	6.6 Gal
Maximum liquid flow •	8 L/min
Work Cycle •	30 minutes' rest per tank consumed.
Type of Fuel •	Unleaded Gasoline
Type of starter •	Recoil starter

Fuel specifications



For better performance and durability use higher-octane gasoline. In Mexico, we suggest using PREMIUM gasoline.

- The sprayer has a 4-stroke air-cooled engine that uses pure unleaded gasoline.
- Do not mix oil with the fuel for any reason.

⚠ WARNING • For any reason, do not use fuels mixed with ethyl alcohol (gasohol), ethanol or methanol for any reason, as they can attract moisture, which causes separation and acid formation during storage. Acidity can damage the engine's fuel system when in storage.

- To avoid engine problems, the fuel system should be drained before storing the sprayer for periods of 30 days or longer. Empty the fuel tank, start the engine and let it run until the fuel lines and carburetor are empty. Next season, use fresh gasoline.
- Never use engine or carburetor cleaners inside the gas tank as permanent damage may result.





Keep your work area tidy and with good lighting.

CAUTION Cluttered and dark areas can cause injuries.



Never use the mixer in explosive environments or where there are flammable liquids present.

DANGER Set the mixer 30 ft. away from the fuel filling up area before starting the motor.



Keep children and passersby at a safe distance while the mixer is operating.

WARNING Distractions can make you loose control and cause accidents.



Avoid making contact with power lines and circuits.

DANGER Find and avoid all power lines and circuits, especially hidden wiring. Also keep away from grounded objects.



Stay always alert, be prudent and use common sense.

CAUTION Even though you are familiar with the use of the mixer do not get distracted while operating the machine. It can cause accidents.

Do not operate the mixer when tired or under the influence of drugs, alcohol or medication.

DANGER A moment of distraction while operating the mixer can cause severe personal injury.

Use the mixer with the guards and protector installed and in good repair.

WARNING Failure to comply with this warning leads to severe personal injury.

Never force the concrete mixer.

CAUTION Working within the range designed assures a better job and is safer.



Store the mixer in a safe place away from the reach of children.

WARNING Motor concrete mixers are dangerous near inexperienced hands.



Wear the right clothes.

WARNING Loose clothing, jewelry or long hair can get tangled in the moving parts.



Keep your hands away from the rotating or moving parts.

WARNING Failure to comply with this warning leads to severe personal injury.



Do not use the mixer in enclosed areas.

DANGER To prevent accumulation of carbon monoxide, an odorless toxic gas potentially deadly.



Use the right personal protection equipment.

CAUTION Using eye protection, anti-dust masks, non-skid safety shoes, helmet, hearing protection and safety gloves considerably reduce the risk of injury.



Turn off the mixer before adjusting, changing accessories or storing.

WARNING Double-check the mixer motor switch is in the OFF position.

Never run the mixer if the switch is not working or is not duly assembled.

WARNING The operator is exposed to severe injury. Take it to repair immediately to a TRUPER Authorized Service Center.

Do not overreach.

CAUTION Good footing and balance give better control of the mixer in unexpected situations.

Prevent unintentional starting.

WARNING Double-check the mixer motor is OFF before leaving or servicing.



Remove any vise fixed in the mixer before starting it.

DANGER Additional tools or wrenches fixed in a rotating part in the mixer can cause severe personal injury.

Service the mixer and double-check it is in the best conditions before starting it.

CAUTION Check carefully the moving parts. See alignment and assembly. Do it periodically. Look for damaged elements or part that is not functioning correctly. Repair immediately in a TRUPER Authorized Service Center.



Accessories.

CAUTION Use only accessories or spare parts indicated in this Manual or certified by TRUPER.

Never leave the concrete mixer running and unattended.

DANGER To prevent severe accidents turn off the mixer after operating and before setting it in a safe place.

Never smoke near fuel.

DANGER Do not smoke near the area where fuel is being supplied or when operating the mixer.





Safety warnings for using sprayers



TRUPER

- The sprayer is designed for agricultural use.
- Do not attempt to spray hot solutions or solutions that can become hot with the sprayer.

⚠ DANGER • Do not attempt to spray gasoline, flammable liquids, caustic alkalis or corrosive acids with the sprayer.



Fuel handling

- Never smoke near the fuel, in the area where the gasoline is dispensed, or where you prepare the mixture with the oil, or when operating the sprayer.
- To reduce the risk of fire or burns, handle fuel carefully, it is highly flammable.
- Do not let gasoline or oil touch your skin.
- Protect your eyes from gasoline and oil splashes. In case of accidental contact, wash immediately with clean water. If irritation persists, consult a doctor.



- Mix and store fuel in a container designed for this purpose.

⚠ WARNING • Mix fuel outdoors away from any sparks or flames.

- Before refueling the sprayer turn off the engine, place it on clear ground and wait for the engine to cool down.

⚠ CAUTION • Clean up any fuel that may have fallen into the sprayer before operating it.

⚠ CAUTION • Check for fuel leaks and correct them before using the sprayer to prevent fire or burn injury.

- Move the sprayer at least 30 feet (9 meters) away from the fueling site before starting the engine.
- Under no circumstances burn spilled fuel for disposal.
- Do not use any type of fuel other than that specified for the sprayer in these instructions.

Before operating the sprayer

⚠ CAUTION • Equip yourself with adequate protection: protective clothing, goggles and respirators with suitable cartridges so as not to inhale the sprayed chemicals.



⚠ WARNING • Familiarize yourself with the first aid procedures described on the chemical container prior to application.

⚠ WARNING • For operator safety, spraying must be carried out strictly in accordance with the chemical instructions. Spraying extremely poisonous chemicals is strictly prohibited.

During the use of the sprayer

⚠ CAUTION • Never leave the sprayer unattended.

- Take care of the sprayer from knocks and falls, especially when it is pressurized.

- Do not exceed the level indicated on the tank when filling the sprayer.

⚠ WARNING • Do not spray while the wind is blowing or in any other condition that may expose you or others to the sprayed chemical.

- Do not remove any parts or attempt to make repairs while the sprayer is pressurized.

- Never carry the sprayer by the hose.

⚠ WARNING • Do not eat, drink, or smoke while using the sprayer.

After using the sprayer

⚠ CAUTION • Always empty and clean the sprayer after each use.

⚠ CAUTION • Clothes used during application should be washed daily, separately from everyday clothes.

Chemicals

⚠ WARNING • Keep the sprayer and chemicals out of the reach of children. Store in a safe place.



Do not store chemicals in the sprayer tank.

⚠ CAUTION • After preparing the compound it should be applied immediately.

⚠ CAUTION • Be sure to read and understand the instructions and precautions for the chemicals to be used with the equipment before use.

⚠ WARNING • Be sure to use the specific chemical in amounts appropriate for the job to be done. Wrong chemicals and quantities can damage the sprayer, spoil the sprayed product, cause hazardous situations and serious ecological damage.

⚠ WARNING • Even if the chemical is stored in a plastic container, it may damage some of the equipment parts. Make sure that the chemical is compatible with high density polypropylene sprayers.

⚠ WARNING • Many of the chemicals commonly used with the sprayer are hazardous if handled or used incorrectly.

⚠ CAUTION • In case of poisoning, seek medical advice immediately and show the doctor the label of the chemical used.

⚠ CAUTION • If the chemical splashes in the mouth or eyes, wash them out with clean water and then see a doctor.

⚠ CAUTION • If the operator has a headache or dizziness, stop work immediately and see a doctor immediately.

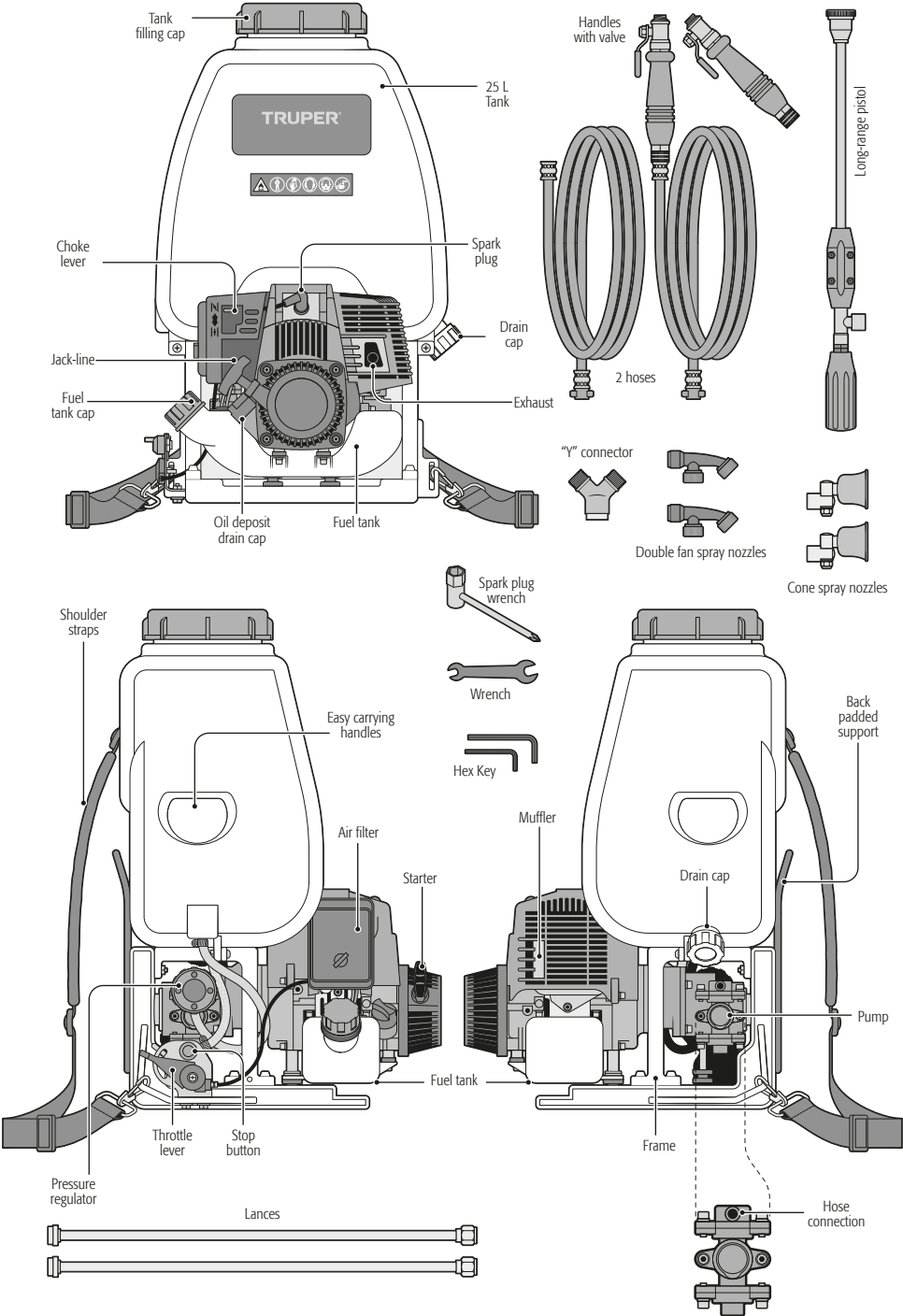

- Check that all connections are tight and have their respective rubber washer.

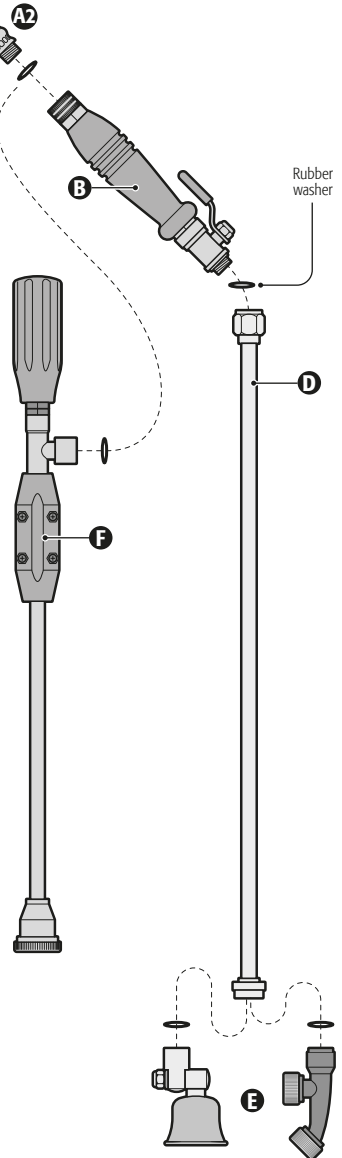

Harness assembly

To mount the straps to the equipment:

1. Insert the ends of each strap (A) behind the mounting bolt (B).
2. Pass the end of the straps through its respective buckle (C) as shown in the image.
3. Place the metal hooks of each strap (D) in the plastic supports (E) on the bottom of the tank.

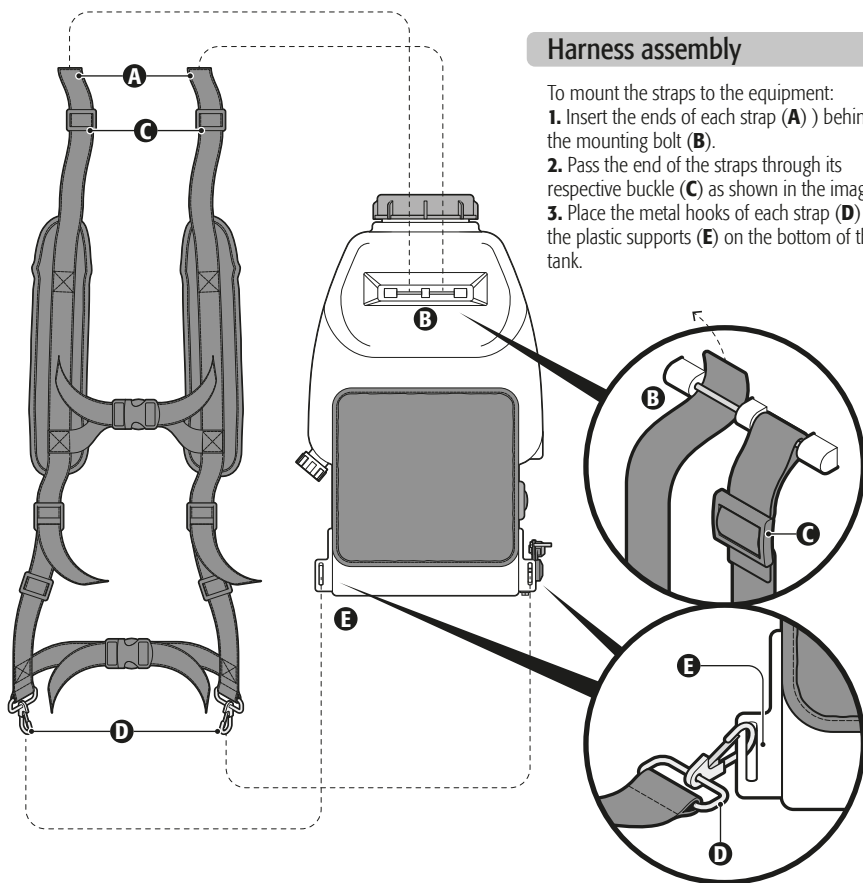

Fuel Supply

- Wait for the engine to cool completely before refueling or oiling.
- Install the equipment on a flat surface.
- Clean around the fuel and oil tank caps to avoid contamination.
- Slowly loosen the fuel tank cap.
- Being careful to avoid spills pour the fuel into the tank (F).
- Before capping the fuel tank check and clean the gaskets. Immediately install the fuel tank cap and tighten it by hand.
- Wipe up any spilled fuel.
- Slowly loosen the oil tank cap.
- Fill the tank with SAE-10W/30 4-stroke gasoline engine oil (G). The oil should reach the top of the oil filler neck.
- Install the oil tank cap and tighten it by hand.
- Always check the oil level before operating the machine.

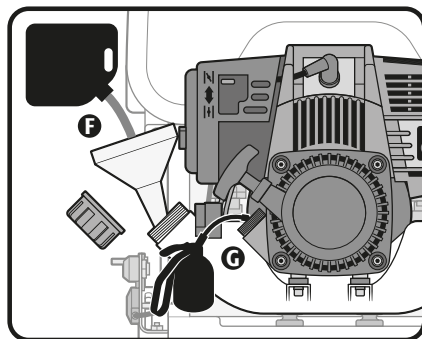

Cold motor ignition

- Install the unit on a firm, level surface.
- Move the throttle lever to one third of the scale (A).
- Press and release the choke bulb 10 times (B).
- Move the choke lever to the "I" (1) position.
- Pull the starter 3 to 5 times (C) to get fuel into the engine. Once the engine starts do not let go of the starter, carefully return it to its initial position to avoid damaging it.
- Once the engine starts slowly install the choke lever in the "II" (2) position.
- Adjust the throttle lever (A) to a position suitable for spraying operation.
- The machine is now ready for operation.

NOTE • The new machine should not be operated in the fully open position for the first 4 hours. The speed should be controlled at 4 000 RPM - 5 000 RPM, thus allowing the motor to have a good adaptation and perform a reliable work.

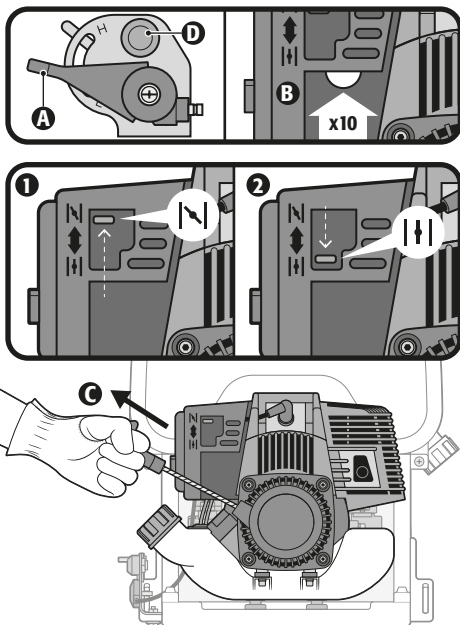

Hot motor ignition

- Move the fuel lever to one third of the scale (A).
- Move the choke lever to the "II" (2) position.
- Pull the starter (C) until the engine starts.
- Adjust the throttle lever (A).

Shutdown

- Move the throttle lever (A) to its lowest position.
- Press the stop button (D), until the motor stops.

Tank filling

CAUTION • When adding the liquid, the engine does not have to stop, but it must be at low speed (i.e., in the minimum throttle position).

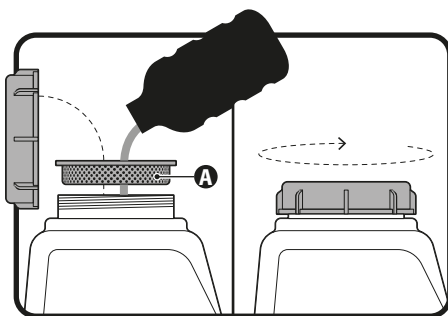

CAUTION • BEFORE USING THE SPRAYER WITH CHEMICALS, YOU MUST TEST THE TANK UNDER RUNNING WATER. If you find any leaks or malfunctioning parts, repair or replace before using any chemicals.

CAUTION • Determine the proper amounts of chemical concentrate and water to prepare the spray mixture. The ratio is indicated on the label of the concentrated chemical container.

- Remove the tank lid and make sure the particle filter (A) is in place.
- Pour the appropriate amount of mixture into the tank, after pouring hold the container down for a minimum of 30 seconds to allow it to empty completely.

CAUTION • Do not exceed the limit marked on the tank.

- Close the tank by screwing the cap clockwise until the tank is perfectly sealed.

Pressure regulation

- The pressure at which the liquid comes out of the pump is regulated at the factory.
- If adjustment is necessary, wait until the motor speed is 5 000 RPM - 6 000 RPM and make adjustments by means of the pressure adjustment knob (A).
- Release the knob lock and turn clockwise to increase pressure and counterclockwise to decrease pressure.

Pump oil

- Remove the padded back support carefully to avoid damaging the plastic fixing rivets.
- Place the sprayer on a stable and flat surface.
- Check the oil level through the plastic oil inspection window. The proper level is when the oil is halfway down the line.
- If the level is insufficient, use SAE 85W-90 oil to refill the pump.

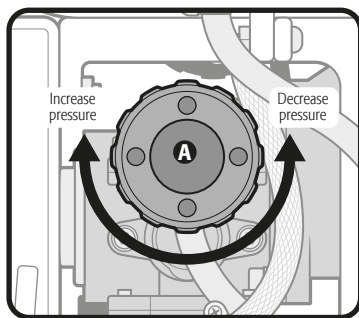

Protective equipment

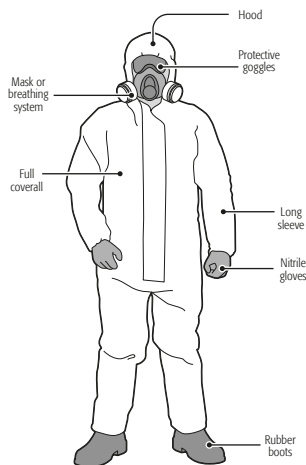

Spraying

- Chemical spraying should be done in cool weather with little wind. For example, in the early morning or late afternoon. This reduces evaporation and drift of the chemicals as well as improves product application.
- Wear all personal protective equipment before carrying the equipment on your shoulders.
- Set the equipment on a table that will support its weight, so that the shoulder straps are off the edge of the table.
- Put your shoulders through the straps and secure the equipment behind your back.
- Adjust the throttle lever to operate the motor.
- Open the handle valve to start spraying.
- After opening the valve keep the handle moving so that the spray is not concentrated in one spot. Failure to do so may result in chemical damage.
- Remember that the operator must face into the wind.
- The lance or gun should form a level angle of about 15°.
- During spraying, the spray tube should oscillate continuously between left and right to increase the spraying range. The advanced steps should match the oscillation speed.

Maintenance

- The following maintenance tasks should be carried out whenever you finish operating the equipment.
- Clean all surfaces.
- Clean the chemical tank with clean water and dry it.
- Check all connections for water or fuel leaks. In case of a leak, repair it immediately.
- Check all bolts for looseness. Tighten them firmly or replace them if necessary.
- After maintenance, the machine should be left to dry in a ventilated place. It must be far from any source of light and avoid sunlight.

- If the equipment is to be stored for a long time, in addition to the above points:
- Completely discharge the fuel from the tank and carburetor. Turn off the choke, pull the starter 3 - 5 times.
- Remove the spark plug and pour some oil into the cylinder. Then pull the starter lightly 2 - 3 times. Then install the spark plug.







Periodic maintenance	Each use	Every 25 h of use	Every 50 h of use	Every 150 h of use	Every 250 h of use
General cleaning	✓				
Air filter cleaning					
Check-fill oil level in the pump					
Carburetor cleaning*					
Spark plug inspection and adjustment*					
Fuel tank cleaning**					
Fuel filter change**					
Fuel Hose Replacement**					
Exhaust and muffler cleaning**					

*Trained user or Truper Authorized Service Center

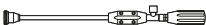
**Truper Authorized Service Center

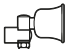
Accessories and spare parts

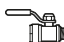
Available accessories and replacement parts list

Component	Code	Part	Description
	101995	LAN-FUG	Long-range pistol
	101996	VAR-FUG	Stainless steel wand
	101997	MANG-FUG	Reinforced hose
	101998	BOQ1-FUG	Cone spray nozzle
	101999	BOQ2-FUG	Double fan spray nozzle
	102031	MAN-FUG	Handle
	102032	VAL-FUG	Valve
	102030	ARN-FUG	Harness
	102033	CB-FUG-254	Carburetor

Problem

Cause

Solution

Equipment does not start.

- Did not press the choke.
- Water mixed with fuel.
- Deterioration or carbon deposits on the spark plug.
- No contact between spark plug and coil wire.

- Press 10 times as indicated. (p. 9)
- Change the fuel.
- Replace the spark plug.
- Check and adjust.

The equipment starts, but does not run at high speed.

- Choke not in fully open position.
- Incorrect fuel ratio.
- Water in fuel.

- Open to full position.
- Change fuel.
- Change fuel.

The equipment works, but has low efficiency.

- The air cleaner or filter is dirty.
- The outside of the cylinder and muffler have carbon deposits.
- Piston, piston ring, cylinder is excessively worn.

- Check and clean.
- Check and clean.
- Go to a TRUPER Authorized Service Center to replace.

The equipment stops when running.

- Out of fuel.
- The coil or spark plug wire is loose.
- The spark plug is covered with carbon.
- The filter is clogged.
- Gasoline has water in it.
- The air hole in the tank cap is clogged.

- Add fuel.
- Check, replace and tighten.
- Replace spark plug.
- Clean filter.
- Change fuel.
- Clean it.

No liquid comes out.

- Inlet and outlet valves are blocked.
- Damage to bearing 6004Z.
- Damage to the piston.

- Replace o clean.
- Go to a TRUPER Authorized Service Center to replace.

Spray volume and pressure is not enough.

- The regulated pressure is not enough.
- The elastic force of the regulating spring is not enough.
- Corrosion-resistant steel ball worn.
- Pressure regulating valve seat worn.

- Make the adjustment.
- Go to a TRUPER Authorized Service Center to replace.

The pressure is adequate but the spray is not.

- Worn piston.
- Piston clearance not adequate.
- Inlet and outlet valves are worn.
- Spraying parts are clogged.

- Go to a TRUPER Authorized Service Center or repairs or replacement.
- Clean the parts.

The spraying mist is uneven.

- The holes in the spraying nozzle are worn out.
- The spraying parts are clogged.

- Go to a TRUPER Authorized Service Center to replace.
- Clean the parts.

If the problems persist despite performing the recommended corrective actions, contact a TRUPER Authorized Service Center.

In the event of any problem contacting a TRUPER Authorized Service Center, please see our webpage **WWW.TRUPER.COM** to get an updated list, or call our toll-free numbers **800 690-6990** or **800 018-7873** to get information about the nearest Service Center.

AGUASCALIENTES	DE TODO PARA LA CONSTRUCCIÓN GRAL. BARRAGÁN #1201, COL. GREMIAL, C.P. 20030, AGUASCALIENTES, AGS. TEL: 449 994 0537
BAJA CALIFORNIA	SUCURSAL TIJUANA AV. LA ENCANTADA, LOTE #5, PARQUE INDUSTRIAL EL FLORIDO II, C.P. 22244, TIJUANA, B.C. TEL: 664 969 5100
BAJA CALIFORNIA SUR	FIX FERRETERÍAS FELIPE ÁNGELES ESQ. RUIZ CORTÍNEZ S/N, COL. PUEBLO NUEVO, C.P. 23670, CD. CONSTITUCIÓN, B.C.S. TEL: 613 132 1115
CAMPECHE	TORNILLERÍA Y FERRETERÍA AAA AV. ÁLVARO OBREGÓN #324, COL. ESPERANZA C.P. 24080 CAMPECHE, CAMP. TEL: 981 815 2808
CHIAPAS	FIX FERRETERÍAS AV. CENTRAL SUR #27, COL. CENTRO, C.P. 30700, TAPACHULA, CHIS. TEL: 962 118 4083
CHIHUAHUA	SUCURSAL CHIHUAHUA AV. SILVESTRE TERRAZAS #128-11, PARQUE INDUSTRIAL BAFAR, CARRETERA MÉXICO CUAUHTÉMOC, C.P. 31415, CHIHUAHUA, CHIH. TEL: 614 434 0052
CIUDAD DE MÉXICO	FIX FERRETERÍAS EL MONSTRUO DE CORREGIDORA, CORREGIDORA # 35, COL. CENTRO, C.P. 06060, CUAUHTÉMOC, CDMX. TEL: 55 5522 5031 / 5522 4861
COAHUILA	SUCURSAL TORREÓN CALLE METAL MECÁNICA #280, PARQUE INDUSTRIAL ORIENTE, C.P. 27278, TORREÓN, COAH. TEL: 871 209 6823
COLIMA	BOMBAS Y MOTORES BYMESA DE MANZANILLO BLVD. MIGUEL DE LA MADRID #190, COL. 16 DE SEPTIEMBRE, C.P. 28239, MANZANILLO, COL. TEL: 314 332 1986 / 332 8013
DURANGO	TORNILLOS ÁGUILA, S.A. DE C.V. MAZURIO #200, COL. LUIS ECHEVERRÍA, DURANGO, DGO. TEL: 618 817 1946 / 618 818 2844
ESTADO DE MÉXICO	SUCURSAL CENTRO JILOTEPEC PARQUE INDUSTRIAL # 1, COL. PARQUE INDUSTRIAL JILOTEPEC, JILOTEPEC, EDO. DE MÉX. C.P. 54257 TEL: 761 782 9101 EXT. 5728 Y 5102
GUANAJUATO	CÍA. FERRETERA NUEVO MUNDO S.A. DE C.V. AV. MÉXICO - JAPÓN #225, CD. INDUSTRIAL, C.P. 38010, CELAYA, GTO. TEL: 461 617 7578 / 79 / 80 / 88
GUERRERO	CENTRO DE SERVICIO ECLIPSE CALLE PRINCIPAL MZ. 1 LT. 1, COL. SANTA FE, C.P. 39010, CHILPANCINGO, GRO. TEL: 747 478 5793
HIDALGO	FERREPRECIOS S.A. DE C.V. LIBERTAD ORIENTE #304 LOCAL 30, INTERIOR DE PASAJE ROBLEDO, COL. CENTRO, C.P. 43600, TULANCINGO, HGO. TEL: 775 753 6615 / 775 753 6616
JALISCO	SUCURSAL GUADALAJARA AV. ADOLFO B. HORN # 6800, COL. SANTA CRUZ DEL VALLE, C.P.: 45655, TLAJOMULCO DE ZUÑIGA, JAL. TEL: 33 3606 5285 AL 90
MICHOACÁN	FIX FERRETERÍAS AV. PASEO DE LA REPÚBLICA #3140-A, COL. EX-HACIENDA DE LA HUERTA, C.P. 58050, MORELIA, MICH. TEL: 443 334 6858

MORELOS	FIX FERRETERÍAS CAPITÁN ANZURES #95, ESQ. JOSÉ PERDIZ, COL. CENTRO, C.P. 62740, CUAUTLA, MOR. TEL: 735 352 8931
NAYARIT	HERRAMIENTAS DE TEPEC MAZATLAN #117, COL. CENTRO, C.P. 63000, TEPEC, NAY. TEL: 311 258 0540
NUEVO LEÓN	SUCURSAL MONTERREY CARRETERA LAREDO #300, 1B MONTERREY PARKS, COLONIA PUERTA DE ANÁHUAC, C.P. 66052, ESCOBEDO, NUEVO LEÓN, TEL: 81 8352 8791 / 81 8352 8790
OAXACA	FIX FERRETERÍAS AV. 20 DE NOVIEMBRE #910, COL. CENTRO, C.P. 68300, TUXTEPEC, OAX. TEL: 287 106 3092
PUEBLA	SUCURSAL PUEBLA AV. PERIFÉRICO #2-A, SAN LORENZO ALMECATLA, C.P. 72710, CUAUTLACINGO, PUE. TEL: 222 282 8282 / 84 / 85 / 86
QUERÉTARO	ARU HERRAMIENTAS S.A. DE C.V. AV. PUERTO DE VERACRUZ #110, COL. RANCHO DE ENMEDIO, C.P. 76842, SAN JUAN DEL RÍO, QRO. TEL: 427 268 4544
QUINTANA ROO	FIX FERRETERÍAS CARRETERA FEDERAL MZ. 46 LT. 3 LOCAL 2, COL. EJIDAL, C.P. 77710 PLAYA DEL CARMEN, Q.R. TEL: 984 267 3140
SAN LUIS POTOSÍ	FIX FERRETERÍAS AV. UNIVERSIDAD #1850, COL. EL PASEO, C.P. 78320, SAN LUIS POTOSÍ, S.L.P. TEL: 444 822 4341
SINALOA	SUCURSAL CULIACÁN AV. JESÚS KUMATE SUR #4301, COL. HACIENDA DE LA MORA, C.P. 80143, CULIACÁN, SIN. TEL: 667 173 9139 / 173 8400
SONORA	FIX FERRETERÍAS CALLE 5 DE FEBRERO #517, SUR LT. 25 MZ. 10, COL. CENTRO, C.P. 85000, CD. OBREGÓN, SON. TEL: 644 413 2392
TABASCO	SUCURSAL VILLAHERMOSA CALLE HELIO LOTES 1, 2 Y 3 MZ. #1, COL. INDUSTRIAL, 2A ETAPA, C.P. 86010, VILLAHERMOSA, TAB. TEL: 993 353 7244
TAMAULIPAS	VM ORINGS Y REFACCIONES CALLE ROSITA #527 ENTRE 20 DE NOVIEMBRE Y GRAL. RODRÍGUEZ, FRACC. REYNOSA, C.P. 88780, REYNOSA, TAMS. TEL: 899 926 7552
TLAXCALA	SERVICIOS Y HERRAMIENTAS INDUSTRIALES PABLO SIDAR #132, COL. BARRIO DE SAN BARTOLOMÉ, C.P. 90970, SAN PABLO DEL MONTE, TLAX. TEL: 222 271 7502
VERACRUZ	LA CASA DISTRIBUIDORA TRUPER BLVD. PRIMAVERA, ESQ. HORTENSIA S/N, COL. PRIMAVERA C.P. 93308, POZA RICA, VER. TEL: 782 823 8100 / 826 8484
YUCATÁN	SUCURSAL MÉRIDA CALLE 33 #600 Y 602, LOCALIDAD ITZINCAB Y MULSAY, MPIO. UMAN, C.P. 97390, MÉRIDA, YUC. TEL: 999 912 2451

Code	Model	Brand
101569	FUG-254	TRUPER®

Warranty. Duration: 1 year. Coverage: parts, components and workmanship against manufacturing or operating defects, except if used under conditions other than normal; when it was not operated in accordance with the instructive; was altered or repaired by personnel not authorized by TRUPER®. To make the warranty valid, present the product, stamped policy or invoice or receipt or voucher, in the establishment where you bought it or in Corregidora 35, Centro, Cuauhtémoc, CDMX, 06060, where you can also purchase parts, components, consumables and accessories. It includes the costs of transportation of the product that derive from its fulfillment of its service network. Phone number 800-018-7873. Made in China. Imported by TRUPER, S.A. de C.V. Parque Industrial 1, Parque Industrial Jilotepec, Jilotepec, Edo. de Méx. C.P. 54257, Phone number 761 782 9100.

Stamp of the business. Delivery date:

